



### 3 bed terraced house to buy in

Ord Terrace, Choppington,  
Northumberland, NE62 5HZ

**£135,000** Offers Over

 x 3  x 3  x 1

Tenure

**Freehold**

### Property features

- ✓ Terraced House
- ✓ Fully Refurbished - High Standard
- ✓ Three Bedrooms
- ✓ New Bathroom & Shower Room
- ✓ EPC Rating D

On Street parking

## Key Information

- ✓ Council Tax: Band A
- ✓ EPC Rating: D
- ✓ Heating supply: Gas

## Description

\*\*\*TERRACED HOUSE - THREE BEDROOMS - FULLY REFURBISHED - HIGH STANDARD - MEDIA WALL TO LOUNGE - NEW KITCHEN & CLOAKROOM - NEW FIRST FLOOR BATHROOM & SHOWER ROOM - PEPECT FIRST TIME BUY - VIEW NOW\*\*\*

Pattinson Estate Agents welcome to the sales market this three bedroom terraced house situated on Ord Terrace in Choppington, Northumberland. A popular location with local schools, shops, amenities and travel links close by. Warmed via gas central heating and with Upvc double glazing throughout the property has undergone a full refurbishment including full re-wire, plastering, flooring, media wall, new kitchen and bathrooms.

A perfect first time buy, we anticipate a high level of interest. Early viewings are essential to avoid disappointment.

Briefly comprising; entrance hallway, lounge, kitchen and ground floor cloaks. To the first floor, three bedrooms, bathroom and additional shower room to bedroom two. Externally to the front a small low maintenance garden with gated access. To the rear a leased garden and single garage with ample parking.

To arrange your viewing please contact our Ashington Team

Council Tax Band: A

Tenure: Freehold

Price: Offers Over £135,000

Property Type: Terraced House

Parking: On Street

Heating: Gas

## Front External

Fenced low maintenance front garden.



## Entrance Hallway

Via main access door to front, stairs to the first floor, spotlights to ceiling.

## Lounge

Window to front, media wall with electric feature fire and TV point, radiator.



## Lounge (Additional)



## Kitchen

Access door to the rear, window to rear. A modern kitchen fitted with a range of high gloss wall, floor and drawer units with marble effect worktops and tiled splashbacks, grey resin sink and drainer with mixer tap, integrated electric oven and hob with chimney style extractor above, spotlights to ceiling, tall wall mounted radiator, herringbone wood effect flooring.



## Kitchen (Additional)



## Ground Floor W.C

Frosted window to rear, push button w.c, pedestal wash hand basin with a tiled splashback, new gas combi boiler, herringbone wood effect flooring, radiator.

## First Floor Landing

Loft access hatch.



## Master Bedroom

Window to rear, En-Suite, radiator.



## Master Bedroom, En-Suite

Fitted with a walk in shower cubicle with chrome fittings and glass screen door, wash hand basin with a tiled splashback, push button w.c, partially tiled walls, chrome heated towel rail, tiled flooring.



## Master Bedroom, En-Suite (Additional)



## Bedroom Two

Window to front, radiator.



## Bedroom Three

Window to front, radiator.



## Bathroom

Freestanding bath tub with chrome fittings, floating wash hand basin with storage, w.c, chrome heated towel rail, tiled flooring.



---

## Bathroom (Additional)



---

## Rear Garden

Storage shed/garage. Rear garden is rented - £75 per annum.



---

## Rear External



Approx Gross Internal Area  
85 sq m / 913 sq ft

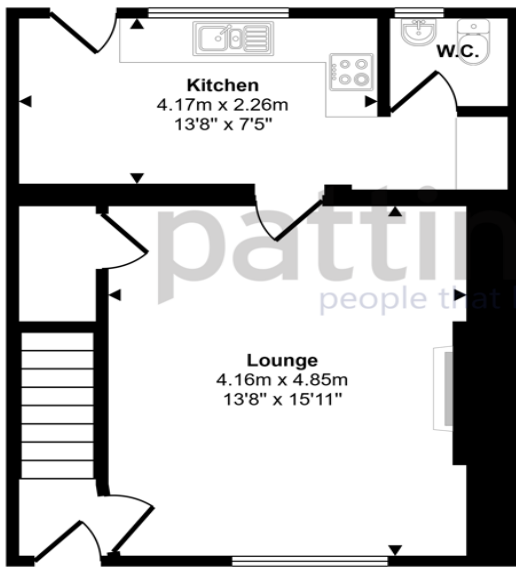

Ground Floor  
Approx 42 sq m / 450 sq ft

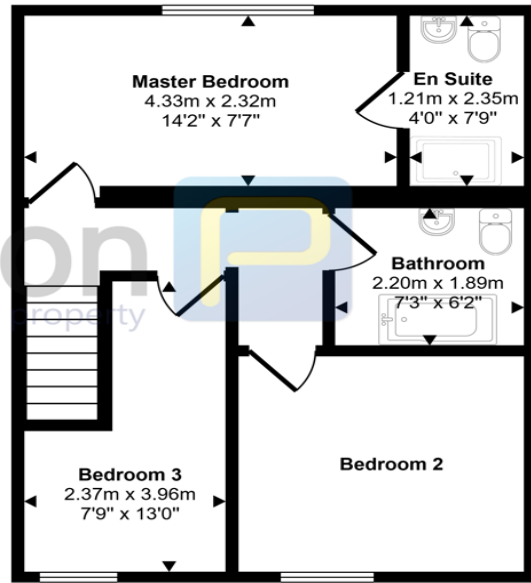

First Floor  
Approx 43 sq m / 464 sq ft

This floorplan is only for illustrative purposes and is not to scale. Measurements of rooms, doors, windows, and any items are approximate and no responsibility is taken for any error, omission or mis-statement. Icons of items such as bathroom suites are representations only and may not look like the real items. Made with Made Snappy 360.

Energy Efficiency Rating		Current	Potential
<i>Very energy efficient - lower running costs</i>			
(92-100) <b>A</b>			
(81-91) <b>B</b>			86
(69-80) <b>C</b>			
(55-68) <b>D</b>		53	
(39-54) <b>E</b>			
(21-38) <b>F</b>			
(1-20) <b>G</b>			
<i>Not energy efficient - higher running costs</i>			
<b>England, Scotland &amp; Wales</b>		EU Directive 2002/91/EC	

Ord Terrace, Choppington, Northumberland, NE62 5HZ

Contact your local branch today for more information on this property:

**1A Brackenthwaite, Leicester, Leicestershire, LE4 7GA, <https://laxmanrealestate.com/contact>**

These particulars, whilst believed to be accurate are set out as a general outline only for guidance and do not constitute any part of an offer or contract. Intending purchasers should not rely on them as statements of representation of fact, but must satisfy themselves by inspection or otherwise as to their accuracy. No person in this firm's employment has the authority to make or give any representation or warranty in respect of the property.

