



## 2 bed apartment to buy in NE37

Collingwood Court, Washington, Tyne and Wear, NE37 3EB

**£20,000** Starting Bid

 x2  x1  x1

Tenure

**Leasehold**

Garage parking

## Property features

- ✓ Two Bedrooms
- ✓ Garage
- ✓ Well maintained outdoor space
- ✓ Tenanted investment
- ✓ EPC Rating C

## Key Information

- ✓ Council Tax: Band A
- ✓ EPC Rating: C
- ✓ Heating supply: Gas

## Description

TENANTED £550 PCM

For sale is this two-bedroom apartment situated in the sought-after area of Washington. This property is a golden opportunity for anyone looking for a savvy investment opportunity.

Upon entry, residents are greeted with a well-laid out floor plan. The property features two spacious bedrooms that offer plenty of storage solutions and room to personalise.

The living area doubles as a reception room, providing a welcoming space that is saturated with natural light, creating a bright and airy ambiance, ideal for both entertaining and unwinding. Situated off this space is a bathroom.

The property is complete with a sizeable garage, providing a secure space to park your vehicle or utilise for any additional storage.

Perhaps one of the notable features of this property is the well-maintained outdoor space.

This unique apartment, with its convenient locale, impressive layout, and abundant features, truly is a rare find. Viewing is essential to fully appreciate what is on offer here, so don't hesitate to contact us for more information or to arrange a viewing. A property of this standard will no doubt attract substantial attention.

Council Tax Band: A

Tenure: Leasehold

Length of Lease: 89

Price: Starting Bid £20,000

Property Type: Apartment

Parking: Garage

Heating: Gas

## Lounge

5.20m x 3.10m (17'0" x 10'2")



## Kitchen



## Bedroom 1

3.60m x 2.70m (11'9" x 8'10")



## Bedroom 2

3.90m x 2.80m (12'9" x 9'2")



## Bathroom



## Balcony



---

## Exterior



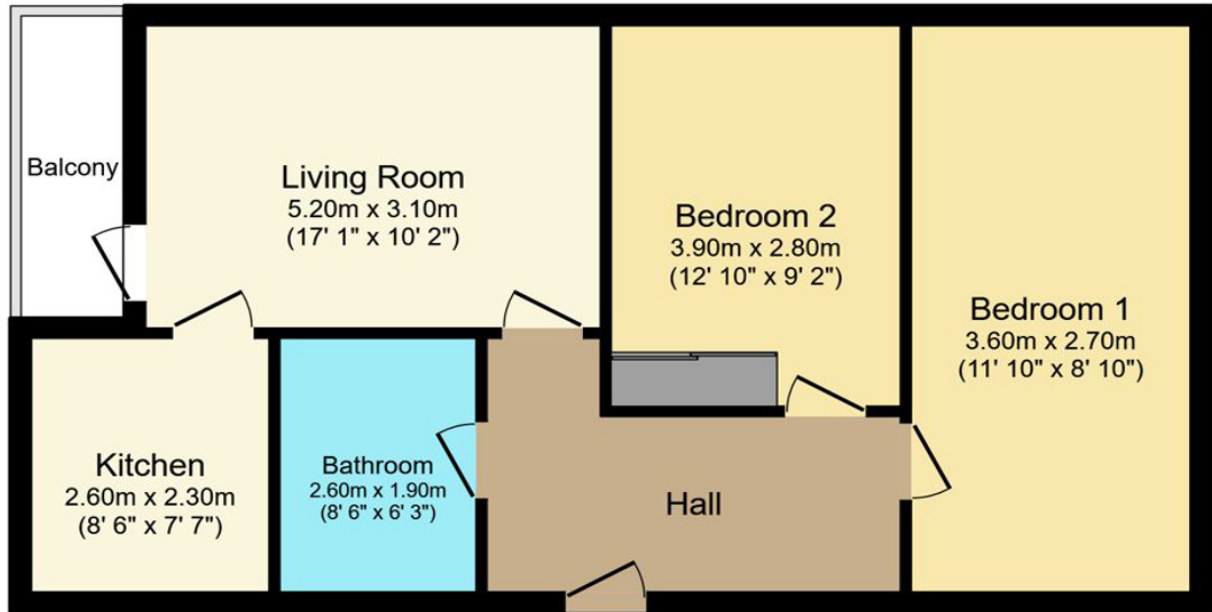

Total floor area: 61.5 sq.m. (662 sq.ft.)

This floor plan is for illustrative purposes only. It is not drawn to scale. Any measurements, floor areas (including any total floor area), openings and orientations are approximate. No details are guaranteed, they cannot be relied upon for any purpose and do not form any part of any agreement. No liability is taken for any error, omission or misstatement. A party must rely upon its own inspection(s). Powered by www.Propertybox.io

Energy Efficiency Rating		
	Current	Potential
<i>Very energy efficient - lower running costs</i>		
(92-100) <b>A</b>		
(81-91) <b>B</b>		
(69-80) <b>C</b>	72	77
(55-68) <b>D</b>		
(39-54) <b>E</b>		
(21-38) <b>F</b>		
(1-20) <b>G</b>		
<i>Not energy efficient - higher running costs</i>		
<b>England, Scotland &amp; Wales</b>		EU Directive 2002/91/EC 

Collingwood Court, Washington, Tyne and Wear, NE37 3EB

Contact your local branch today for more information on this property:

**1A Brackenthwaite, Leicester, Leicestershire, LE4 7GA, <https://laxmanrealestate.com/contact>**

These particulars, whilst believed to be accurate are set out as a general outline only for guidance and do not constitute any part of an offer or contract. Intending purchasers should not rely on them as statements of representation of fact, but must satisfy themselves by inspection or otherwise as to their accuracy. No person in this firm's employment has the authority to make or give any representation or warranty in respect of the property.

